

# Towbar

## 6189

Audi

- A4 (B8) 09/2007 - 11/2015
- A4 Avant (B8) 04/2008 - 11/2015
- A4 Allroad Quattro (B8) 06/2009 - 12/2015
- A5 06/2007 - 09/2016
- A5 Sportback 09/2009 ->
- A5 Cabrio 2009 ->
- S4 / S5 / S5 Sportback (incl. S-line)

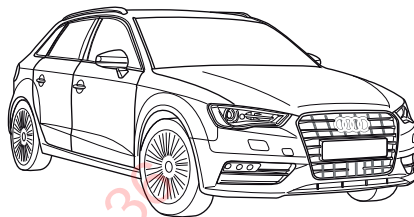

**ФАРКОЛ.РФ**

**+7 (495) 669-38-36**

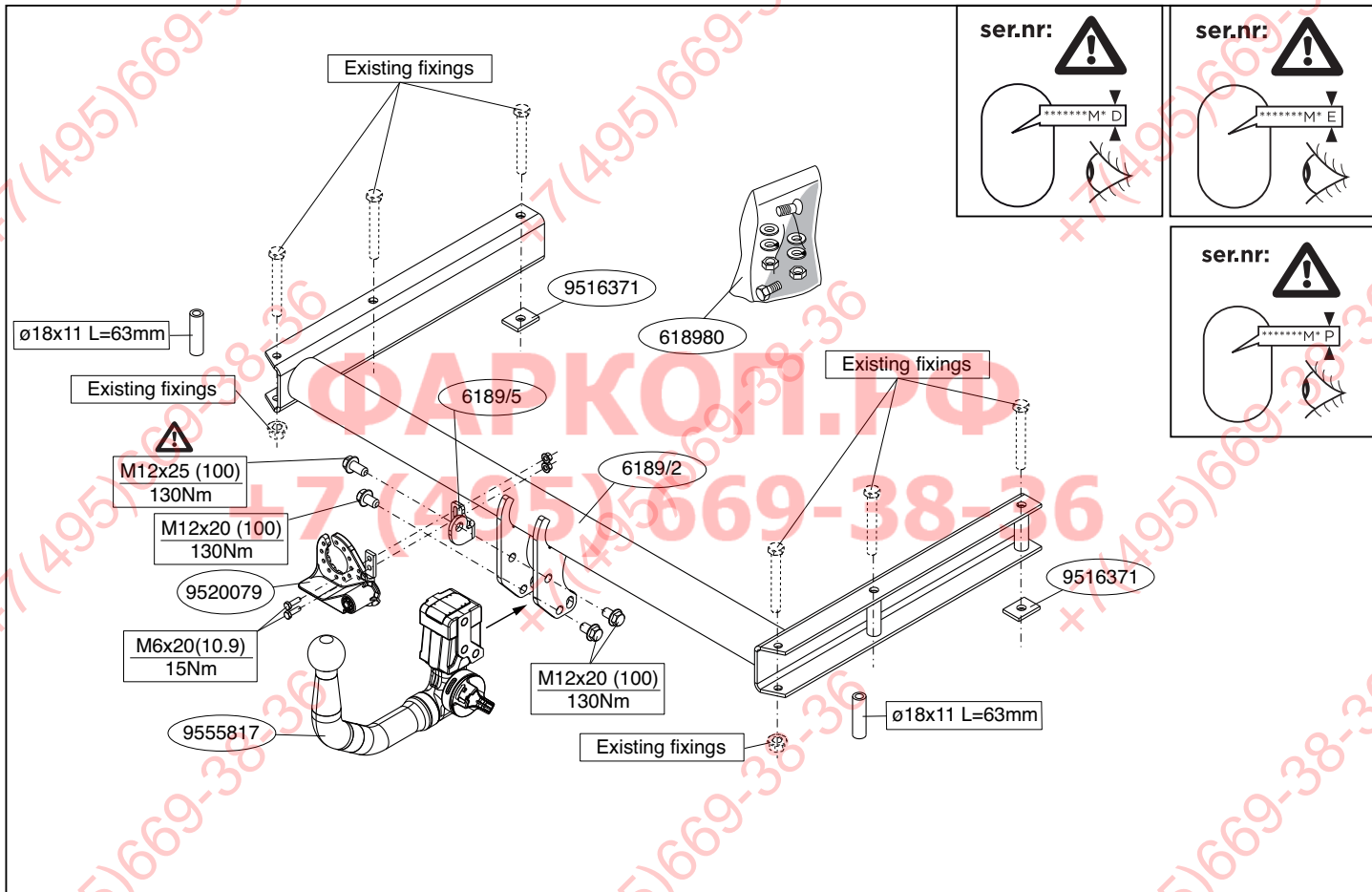

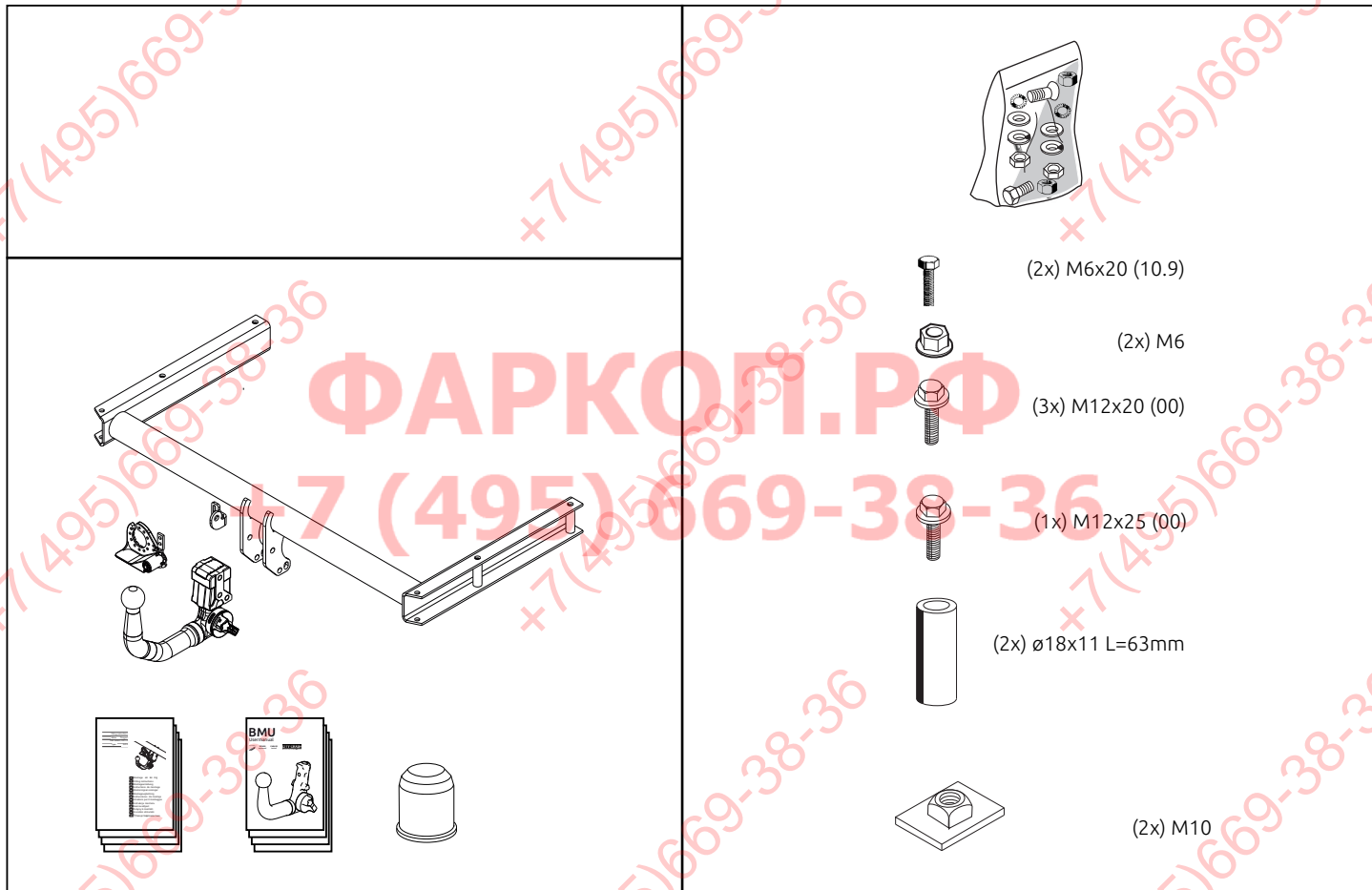

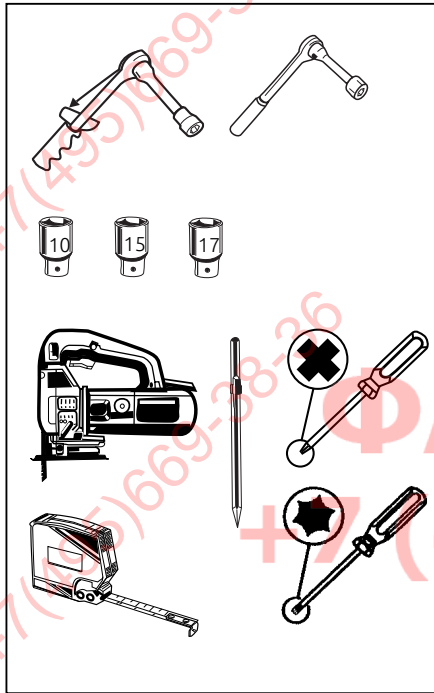

**Couplingsclass: A50-X**

**euro tested**

**Approved**

E11 55R 0110857

ECE R55

**D-Value : 11,1 kN**

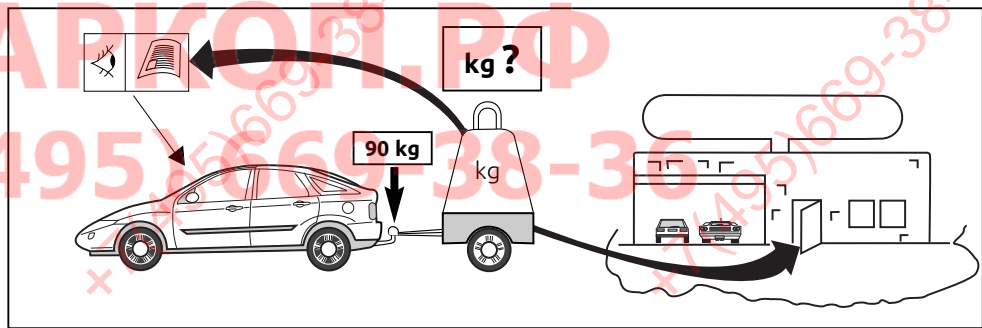

**10.9**

**10**

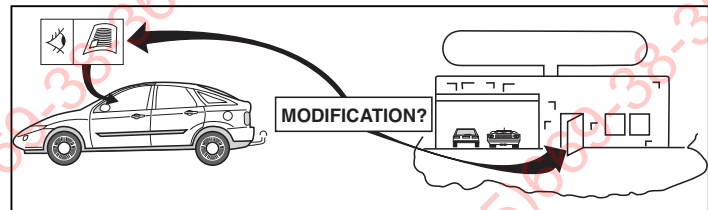

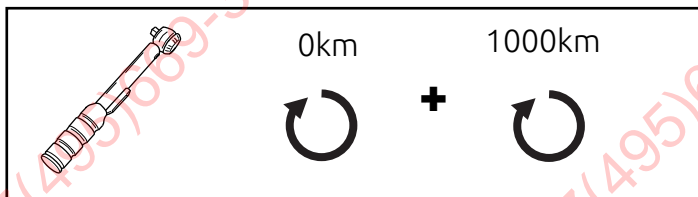

**NOTE:**

**\* Should this installation process entail the cutting of the bumper-conformation MUST be obtained by the installation engineer of the customer's acceptance prior to completion. Thule Towing Systems do not accept responsibility for any matters arising as a result of this miscommunication.**

**All measurements are in mm!**

**HINWEISE:**

- \* Die für das Fahrzeug zugelassene Anhängelast ist den Fahrzeug Unterlagen zu entnehmen. Bei Änderungen des Fahrzeuggewichtes muß die höchstzulässige Anhängelast gegebenenfalls aus dem D-Wert nachgerechnet werden. Auskunft hierüber kann Ihr Fachhändler oder der TÜV geben.
- \* Elektrische Anlage gemäß StVZO anbringen.

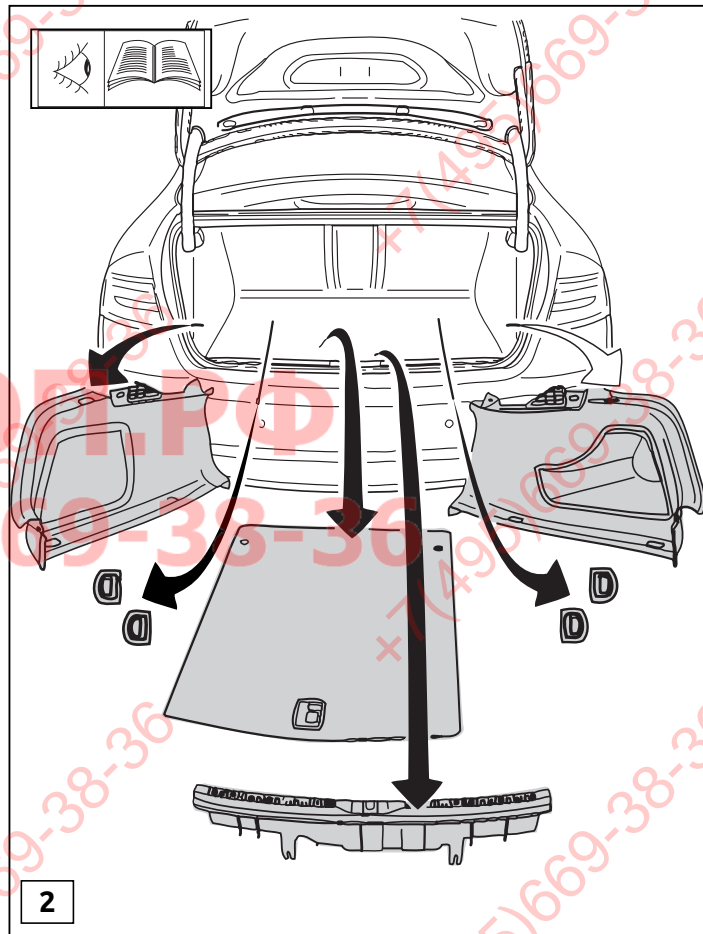

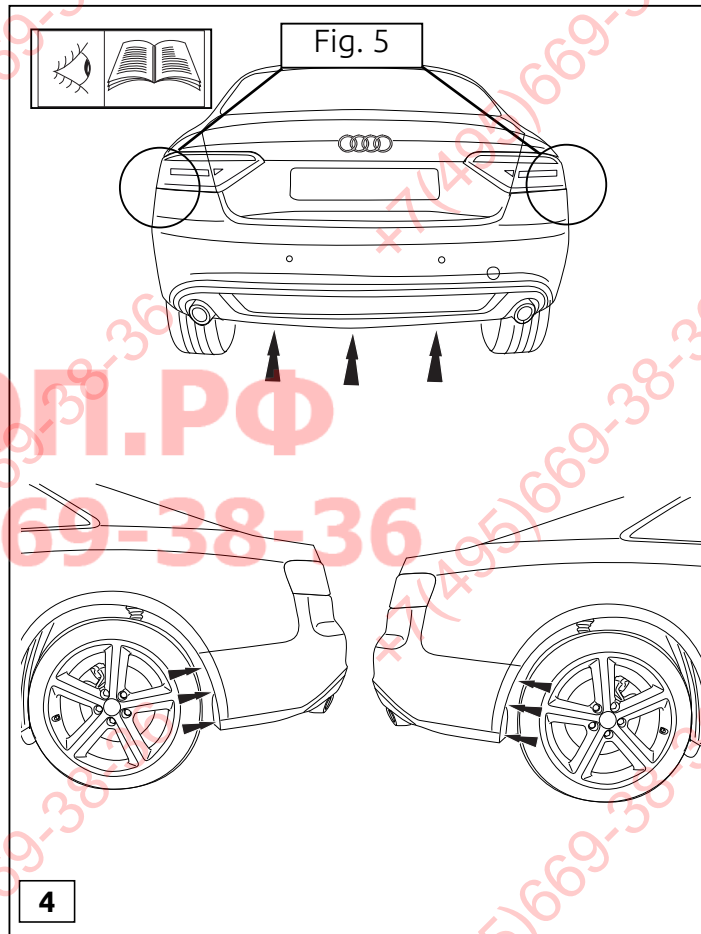
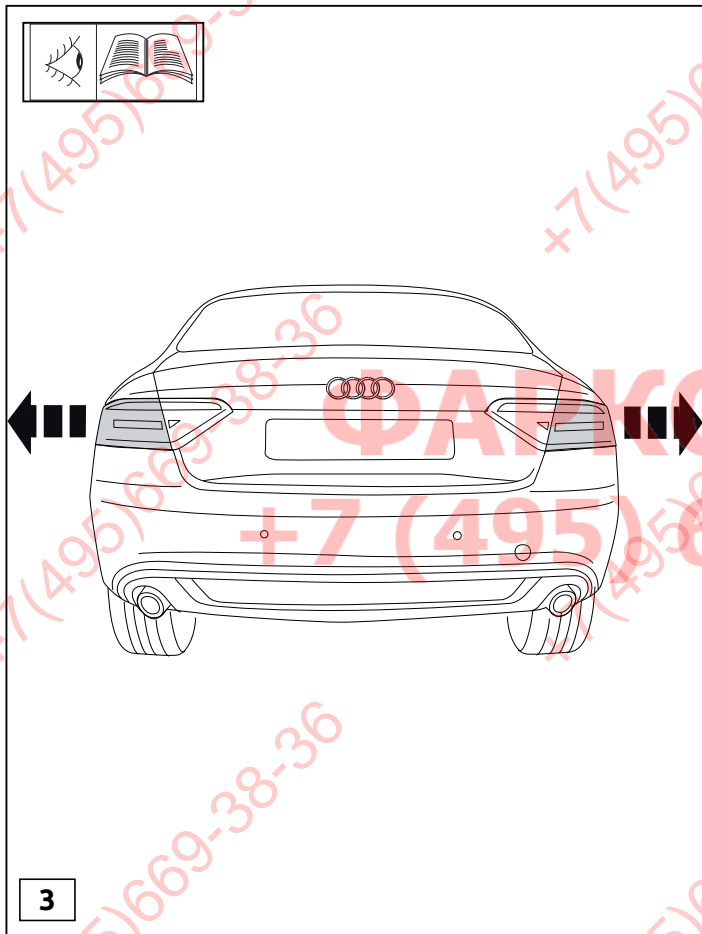

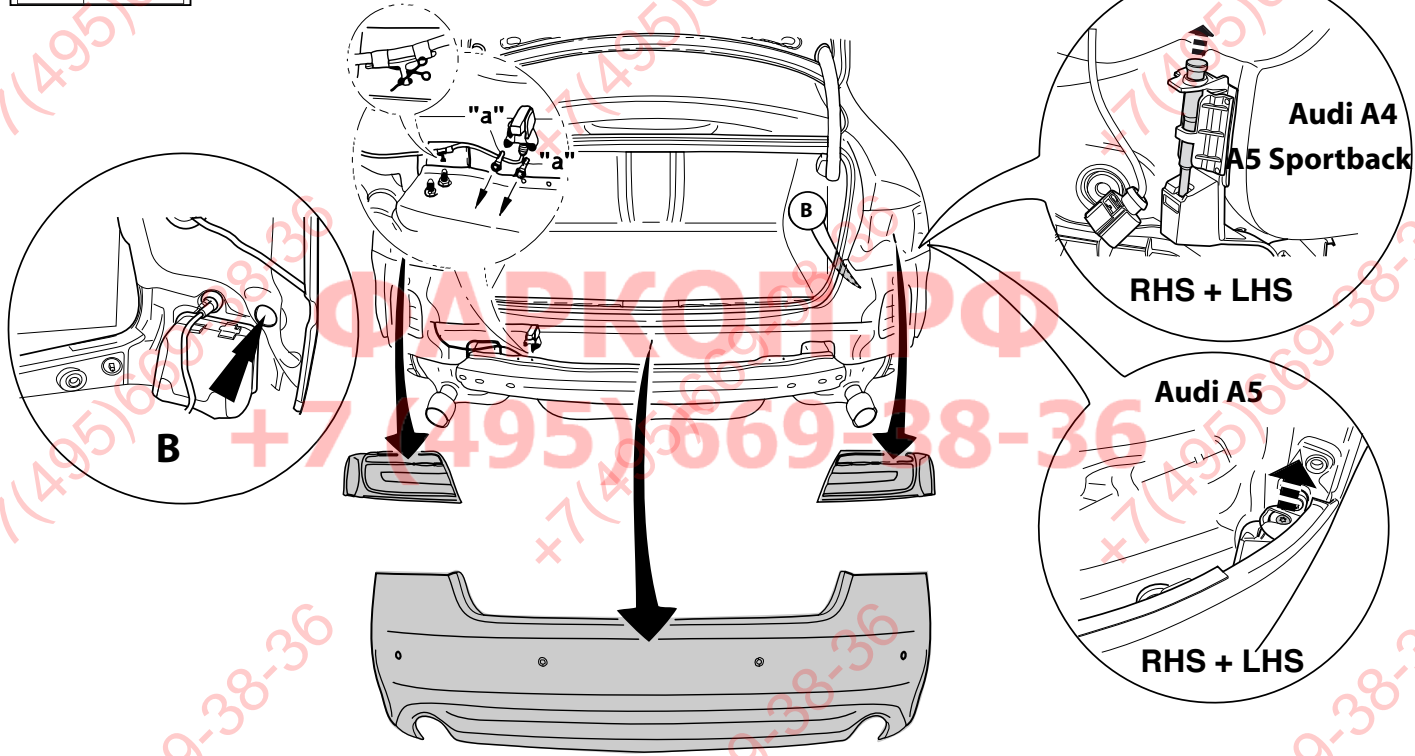

5



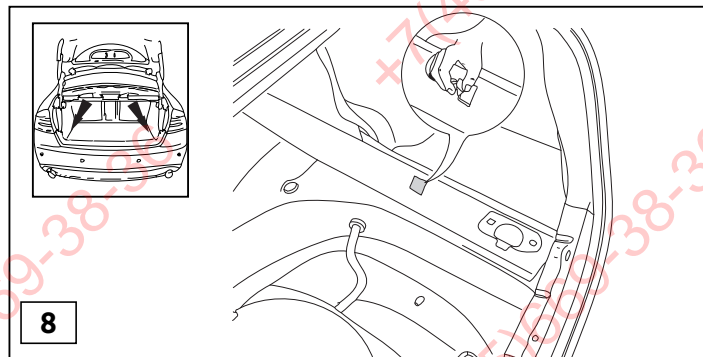
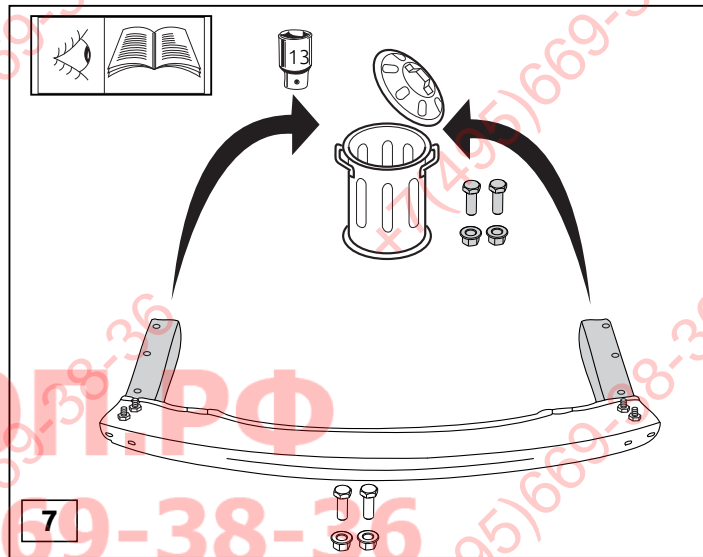
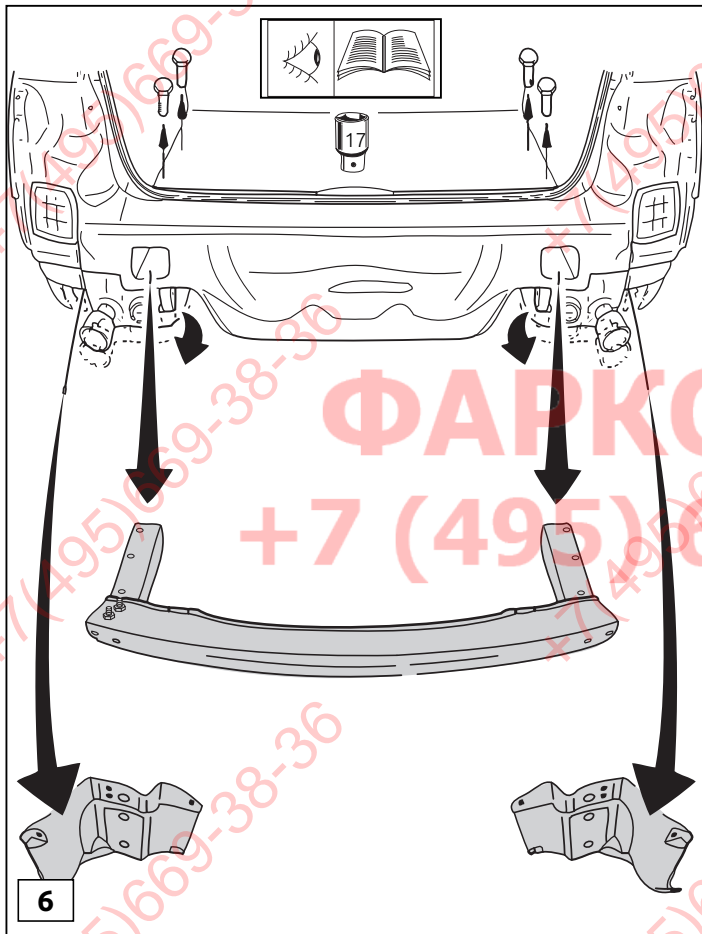

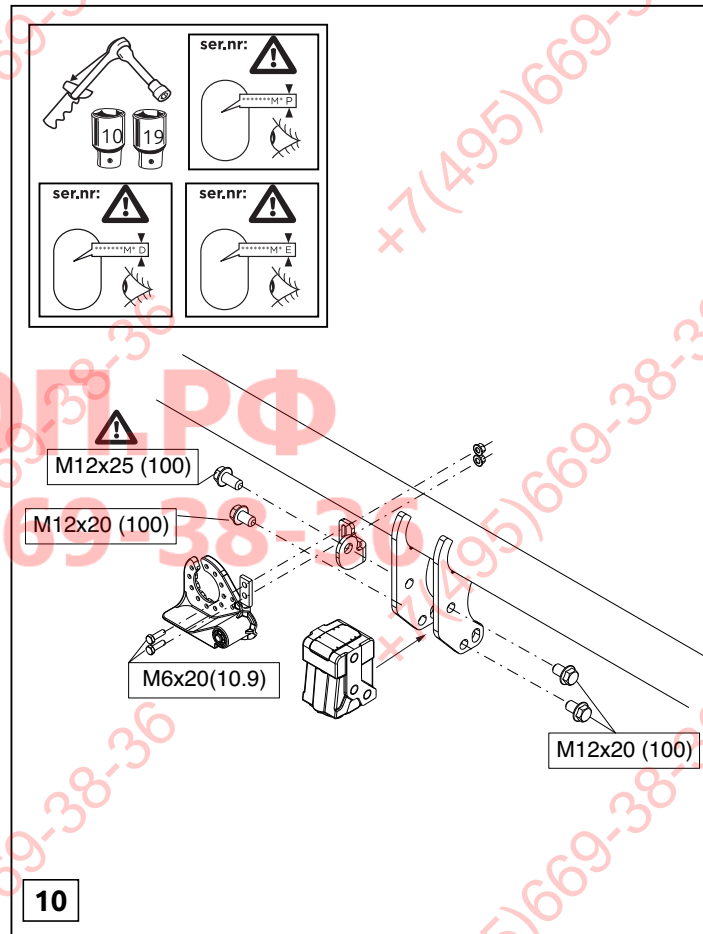
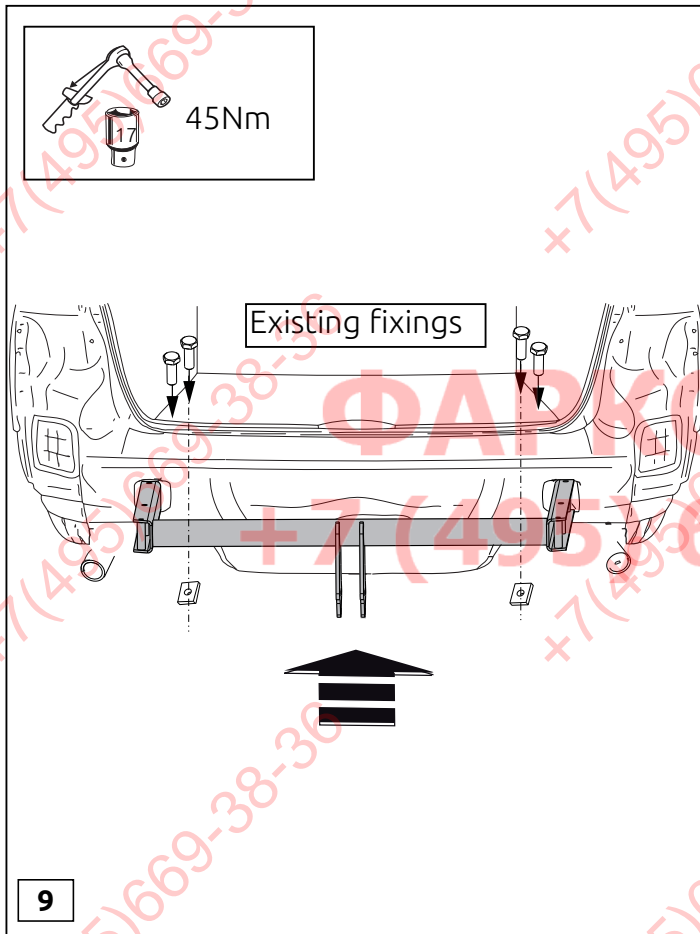

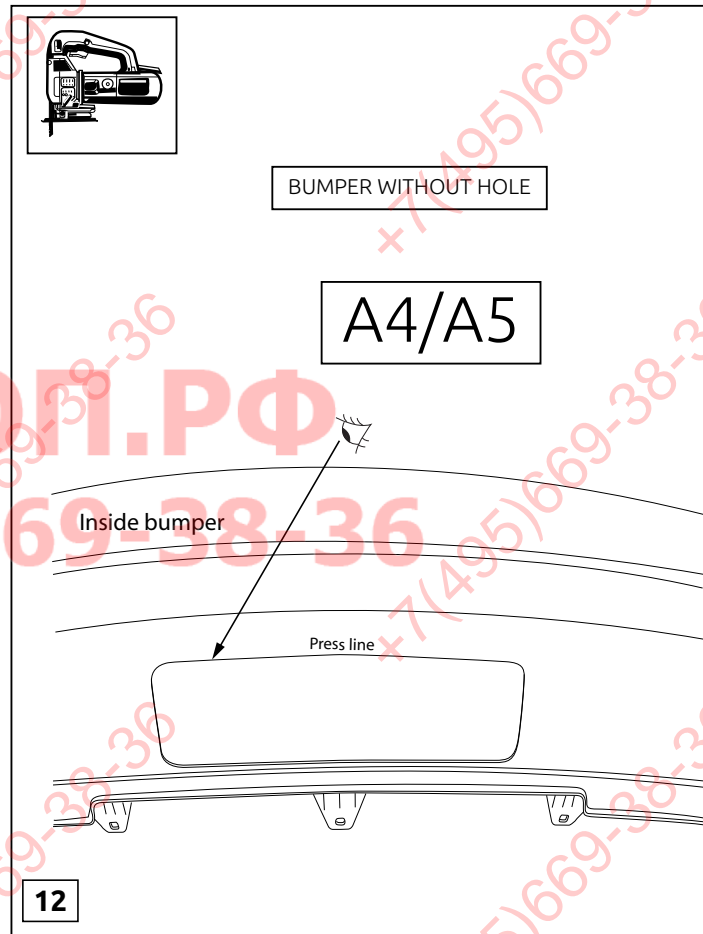
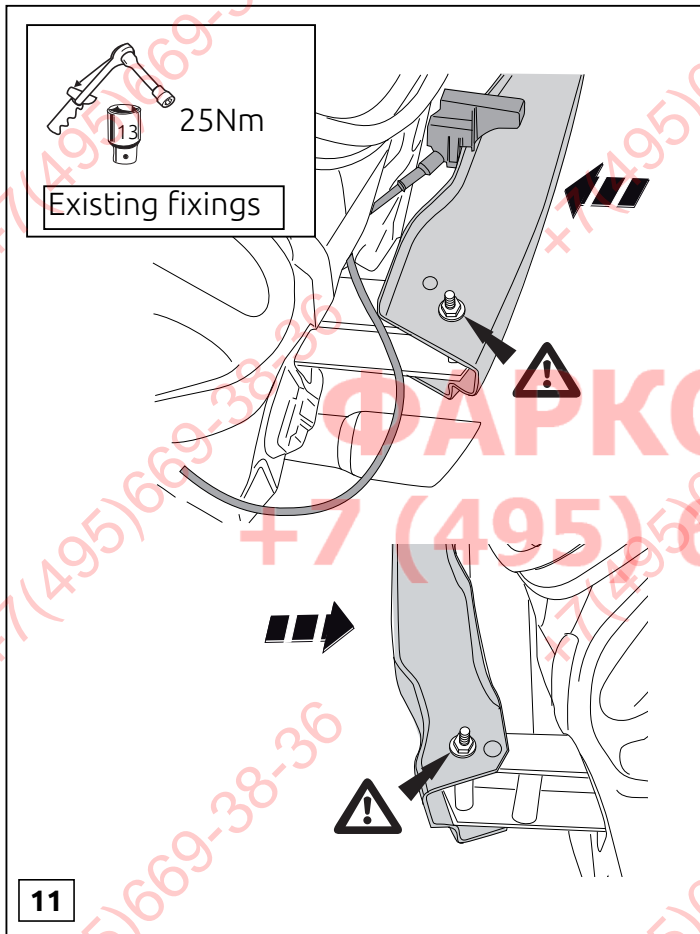

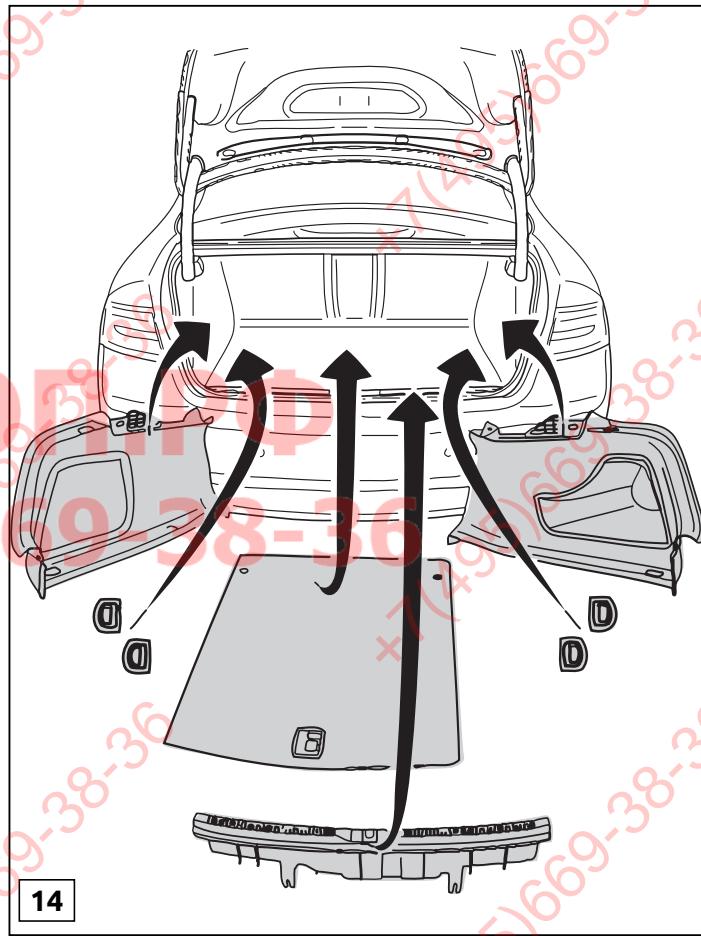
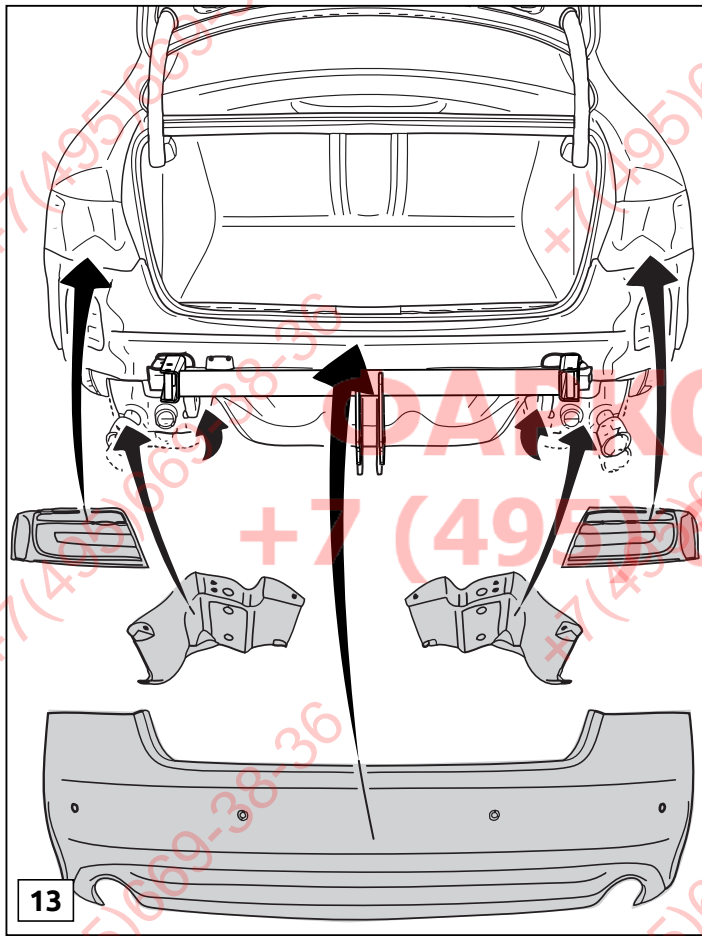

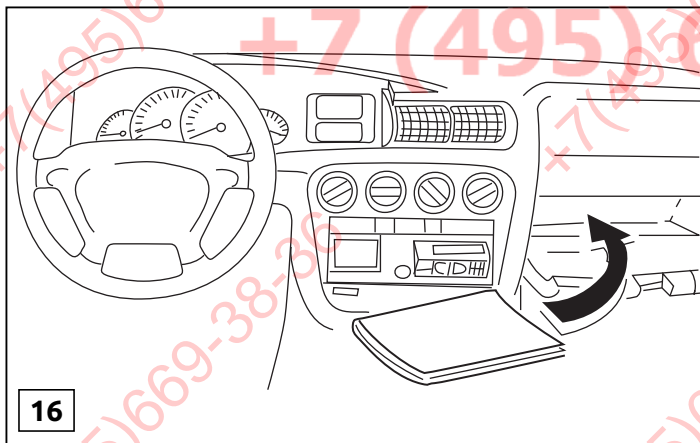
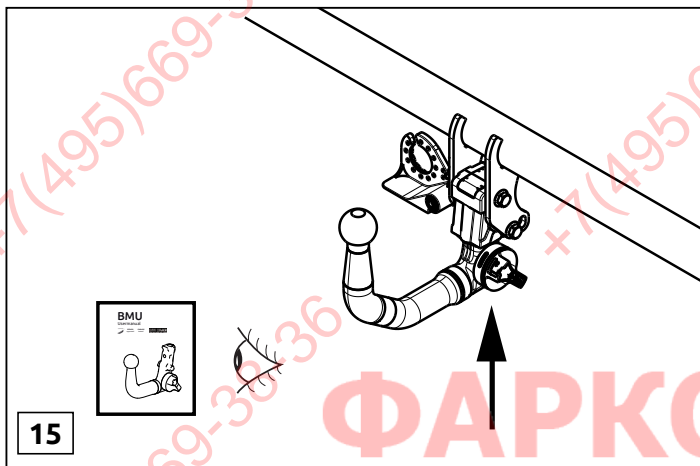

+7(495)669-38-36

+7(495)669-38-36

+7(495)669-38-36

+7(495)669-38-36

+7(495)669-38-36

+7(495)669-38-36

**ФАРКОП.РФ**

**+7 (495) 669-38-36**

+7(495)669-38-36

+7(495)669-38-36

+7(495)669-38-36

+7(495)669-38-36

+7(495)669-38-36

+7(495)669-38-36

+7(495)669-38-36

+7(495)669-38-36

+7(495)669-38-36

**ФАРКОП.РФ**

**+7 (495) 669-38-36**

+7(495)669-38-36

+7(495)669-38-36

+7(495)669-38-36