

Fitting instructions

Make: Hyundai

Santa Fe (CM); 2006->

Type: 4657

ФАРКОГ.РФ

+7 (495) 669-38-36

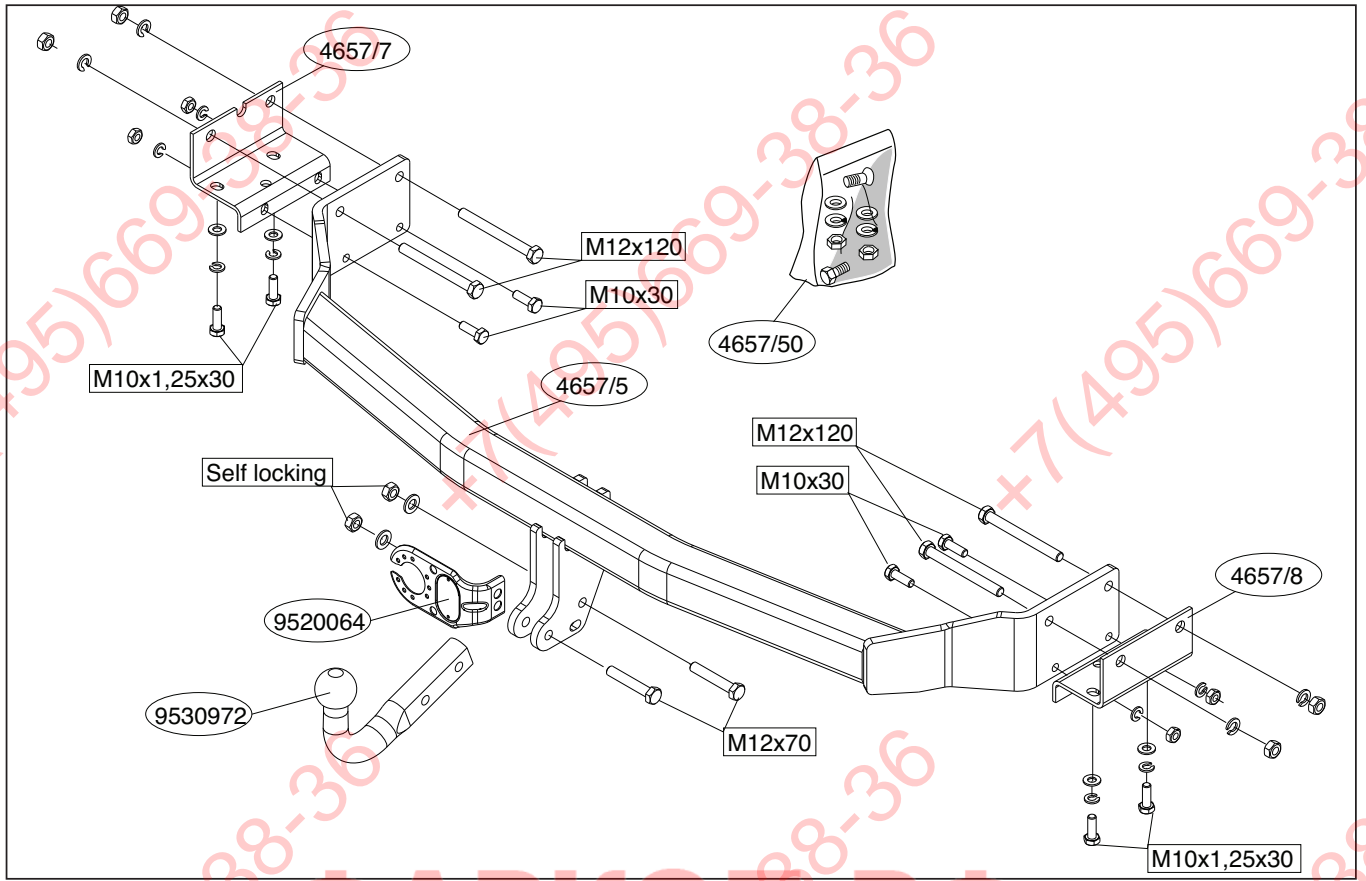

© 465770/25-01-2012/1

ФАРКОП.РФ

+7 (495) 669-38-36

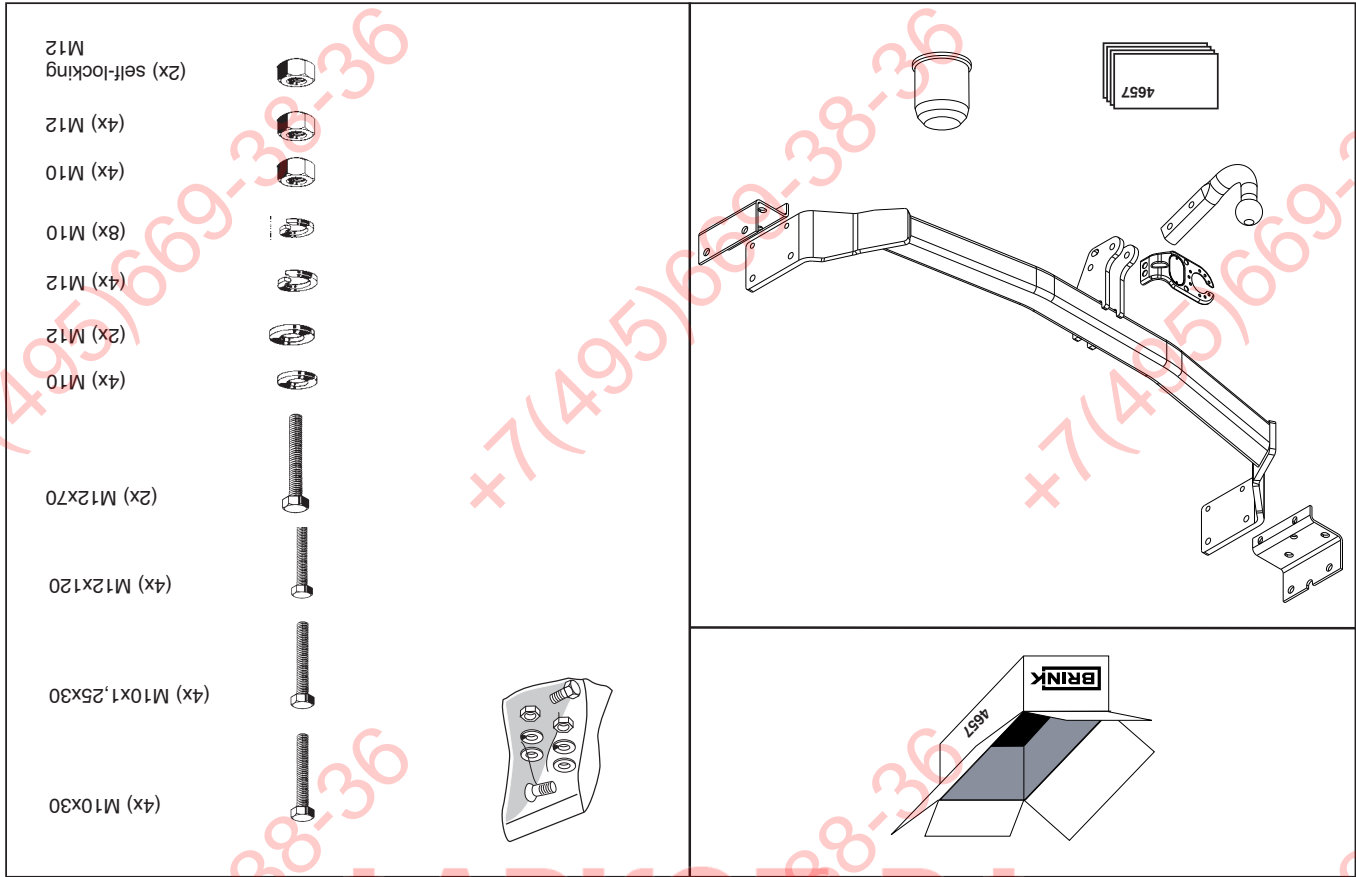

ФАРКОП.РФ

+7 (495) 669-38-36

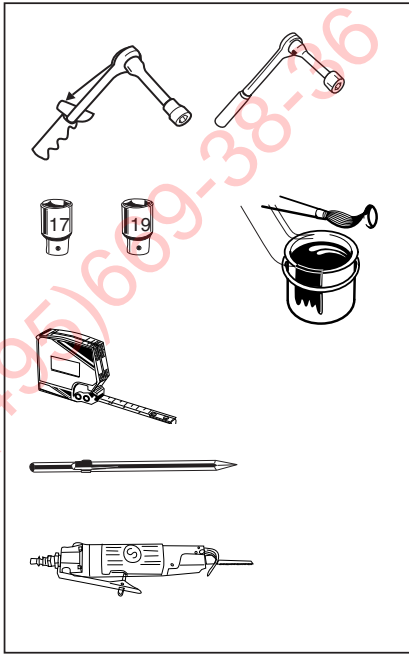

Couplingsclass: A50-X

euro tested

94/20/EC

Approved

e11 00-5940

D-Value : 12,5 kN

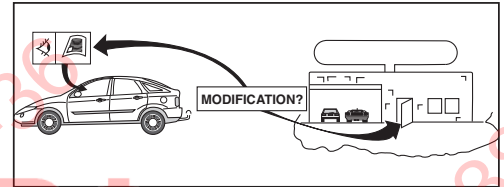
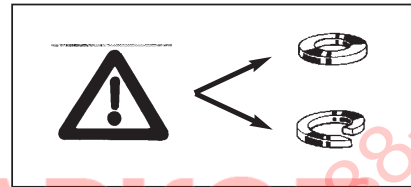
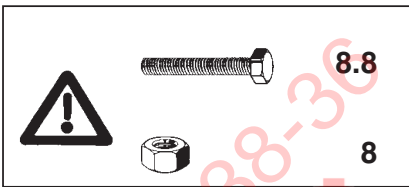
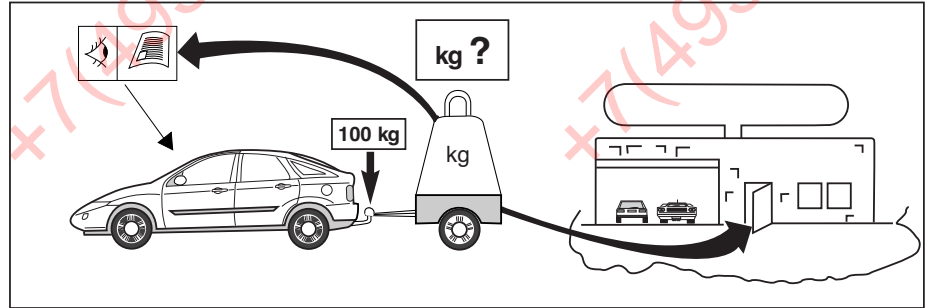

© 465770/25-01-2012/3

ФАРКОП.РФ

+7 (495) 669-38-36

HINWEISE:

- * Die für das Fahrzeug zugelassene Anhängelast ist den Fahrzeug Unterlagen zu entnehmen. Bei Änderungen des Fahrzeuggewichtes muß die höchstzulässige Anhängelast gegebenenfalls aus dem D-Wert nachgerechnet werden.
- * Auskunft hierüber kann Ihr Fachhändler oder der TÜV geben.
- * Elektrische Anlage gemäß SVZO anbringen.

NOTE:

- * Should this installation process entail the cutting of the bumper – confirmation MUST be obtained by the installation engineer of the customer's acceptance prior to completion. Brink International do not accept responsibility for any matters arising as a result of this miscommunication.

ΦΑΡΚΟΠ.ΡΦ

Torque settings for nuts and bolts (8.8)

M10	17	46 Nm
M10x1,25	17	53 Nm
M12	19	79 Nm (with self-locking nut)

1000km + 0km

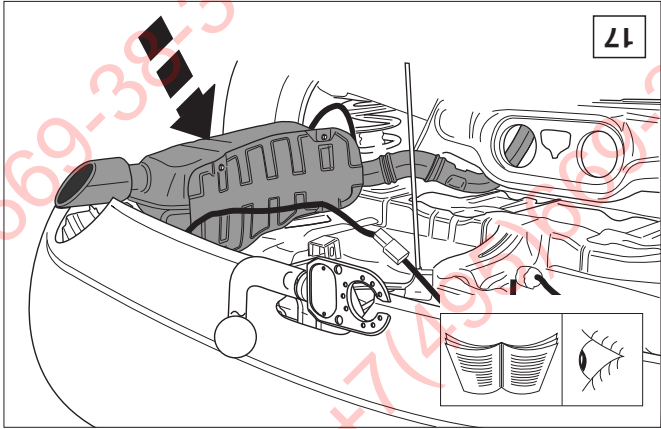
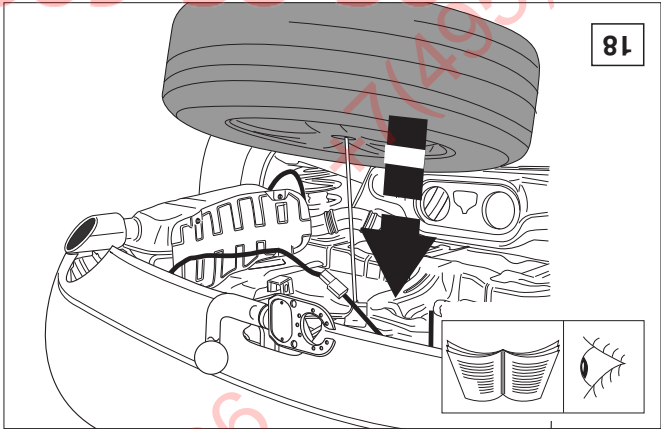
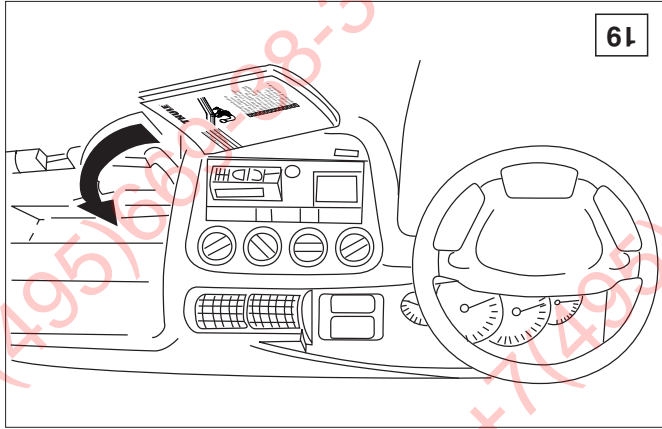

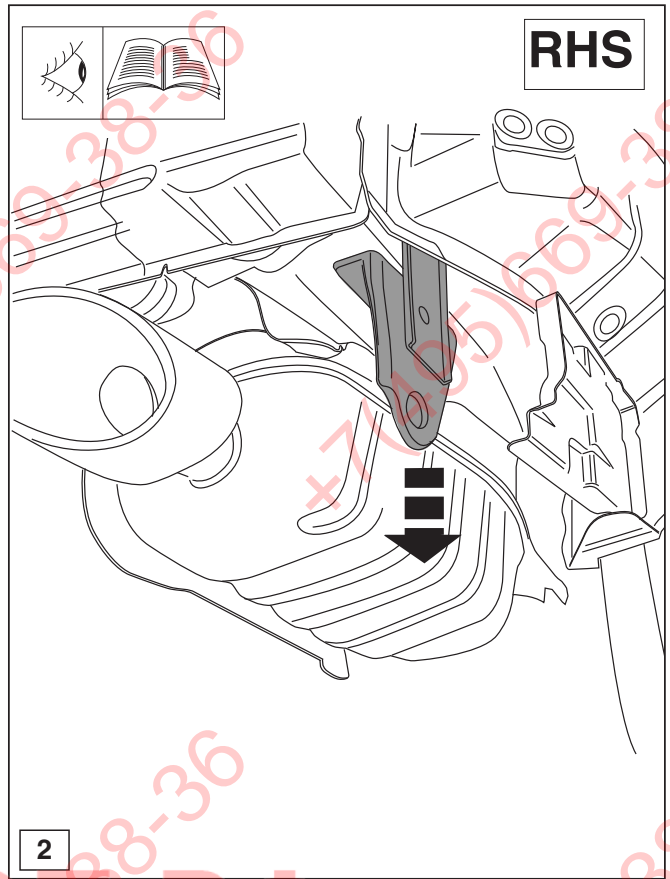
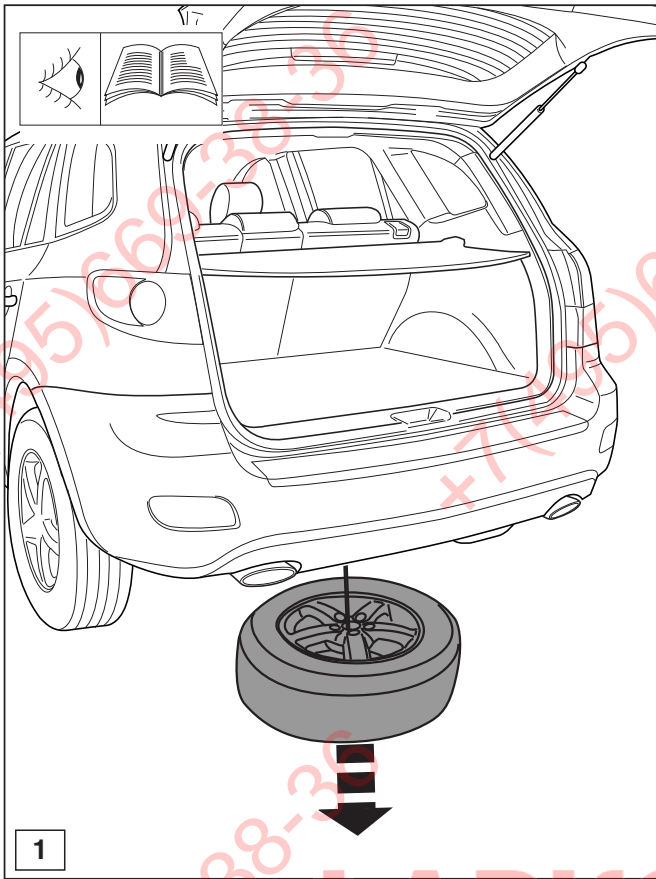

© 465770/25-01-2012/5

ΦΑΡΚΟΤ.ΡΦ

+7 (495) 669-38-36

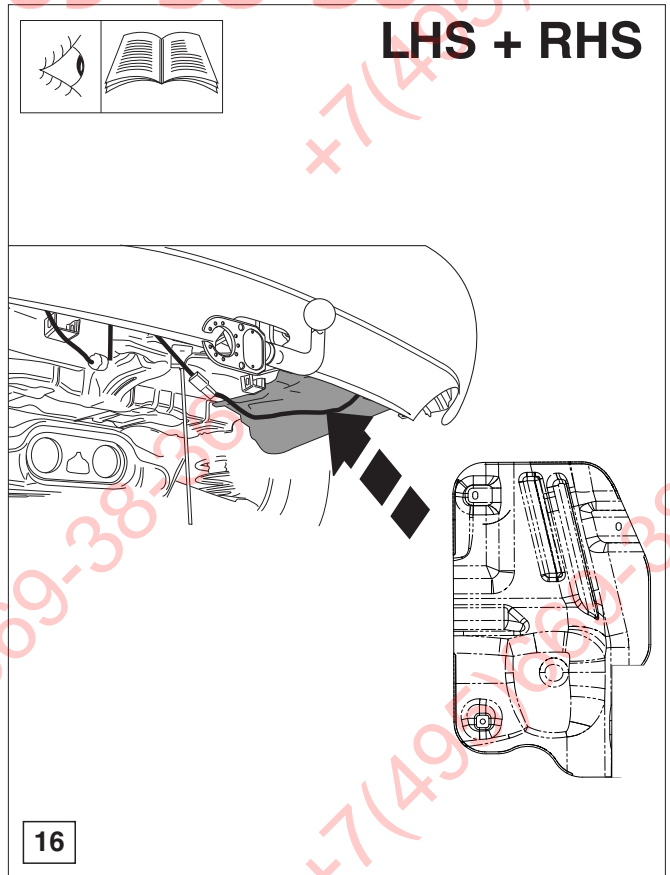
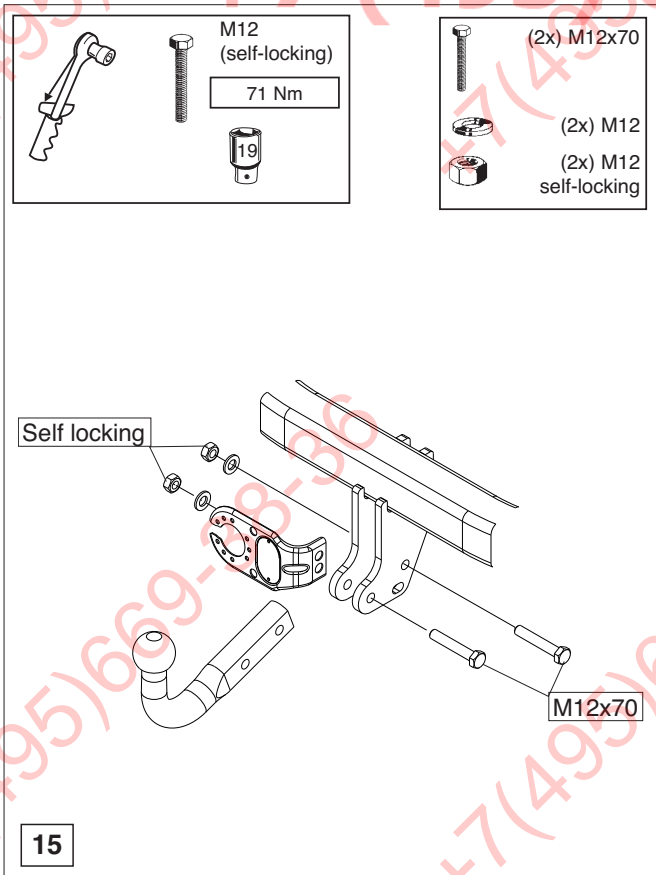

© 465770/25-01-2012/14

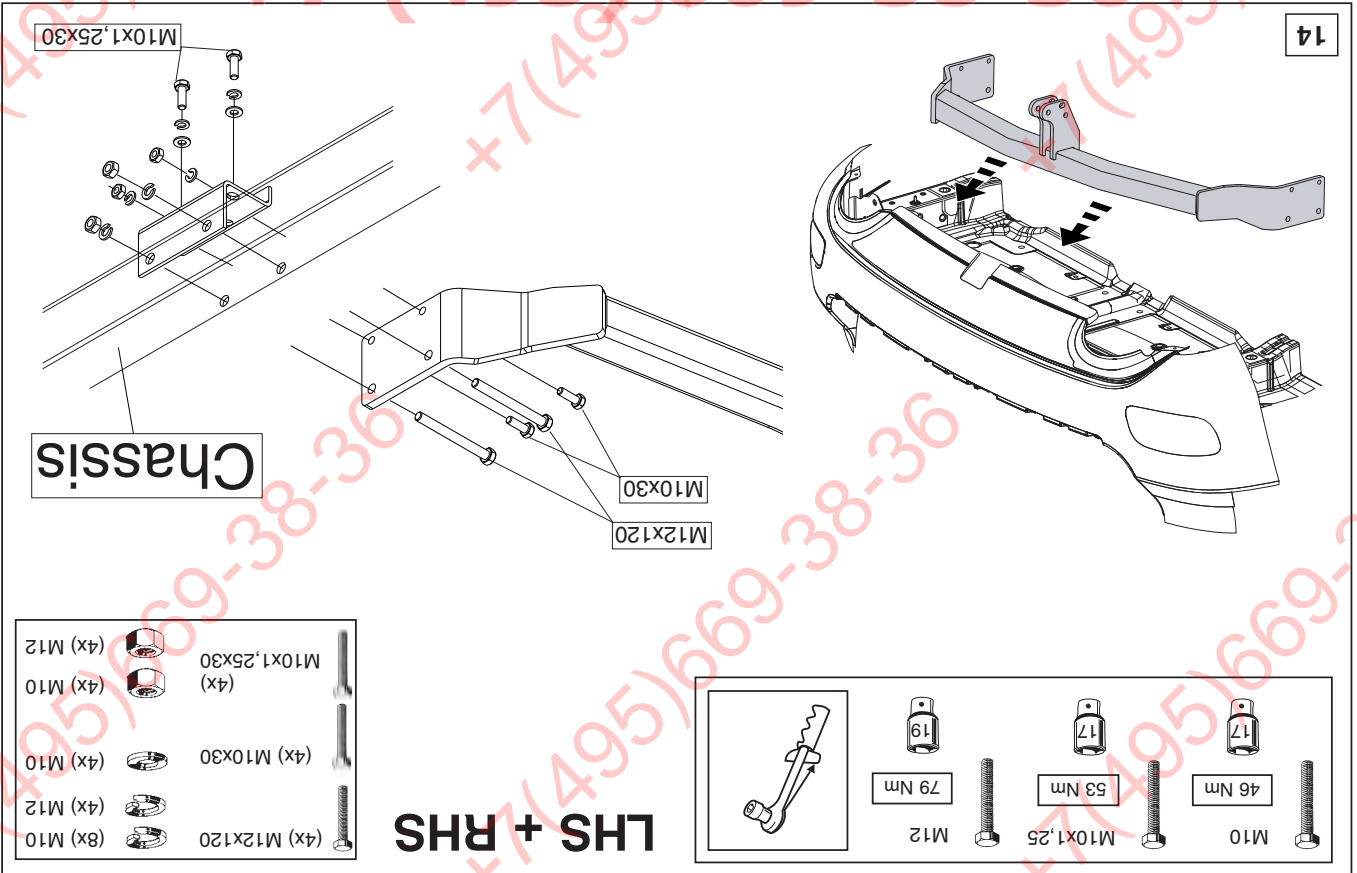
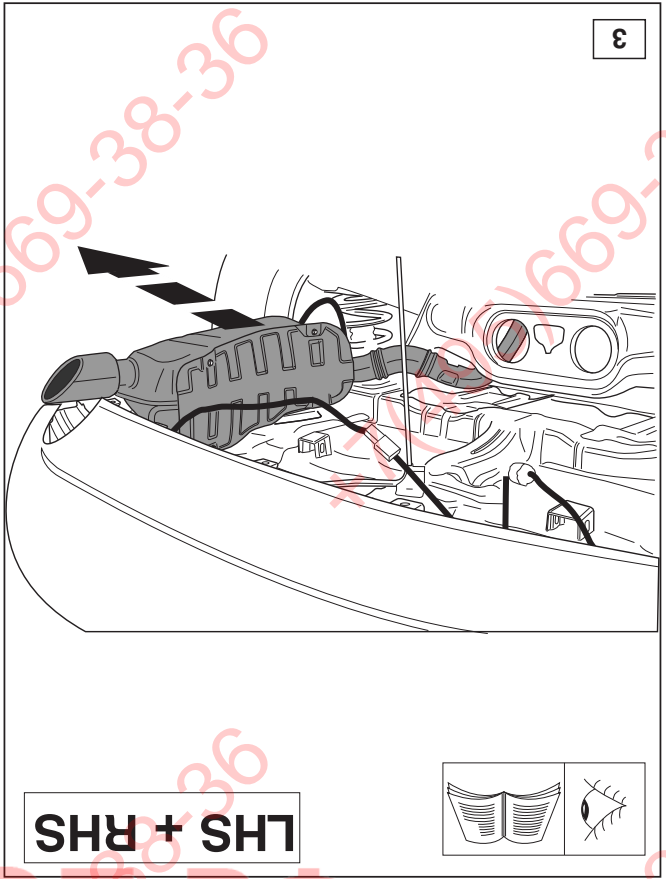
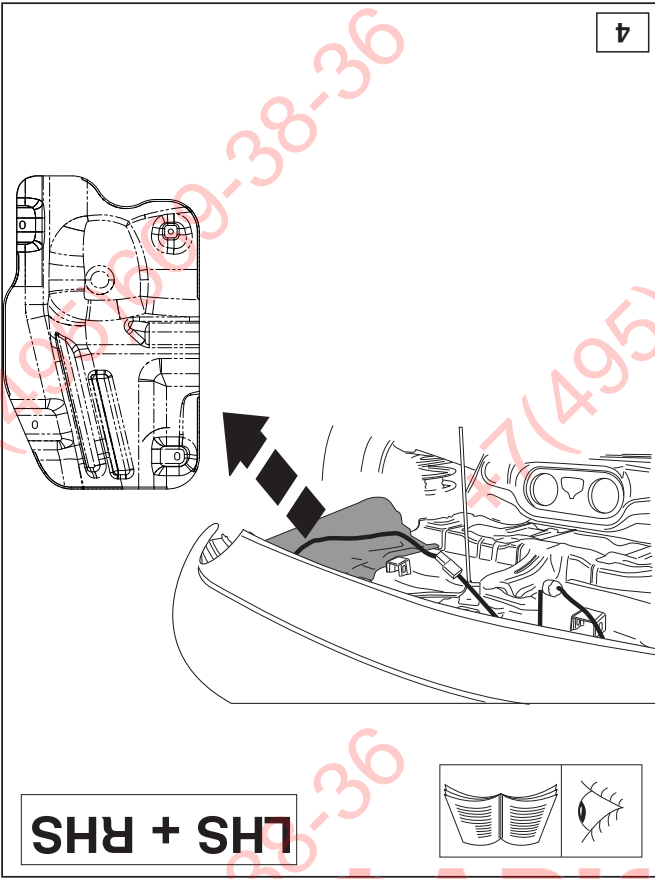

LHS + RHS

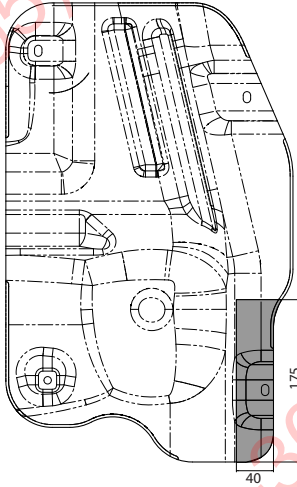
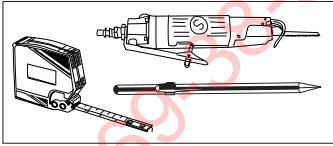

5

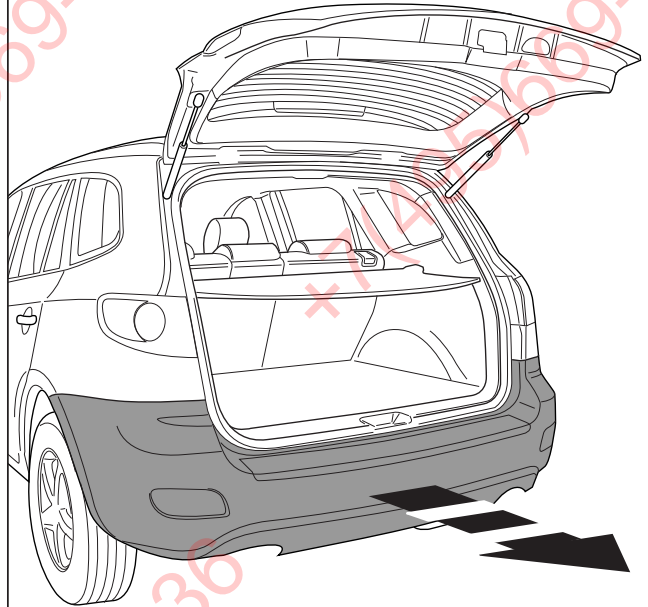
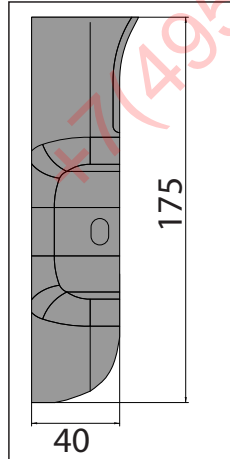

6

© 465770/25-01-2012/7

ФАРКОП.РФ

+7 (495) 669-38-36

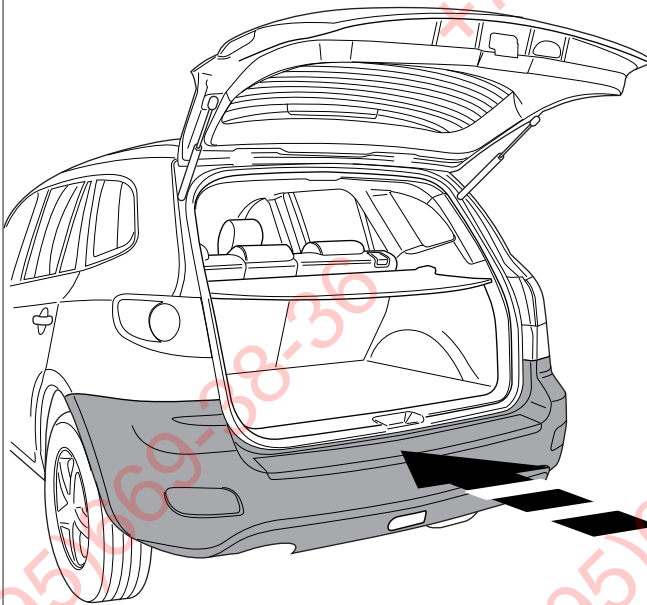
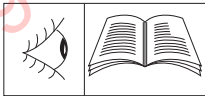

13

© 465770/25-01-2012/12

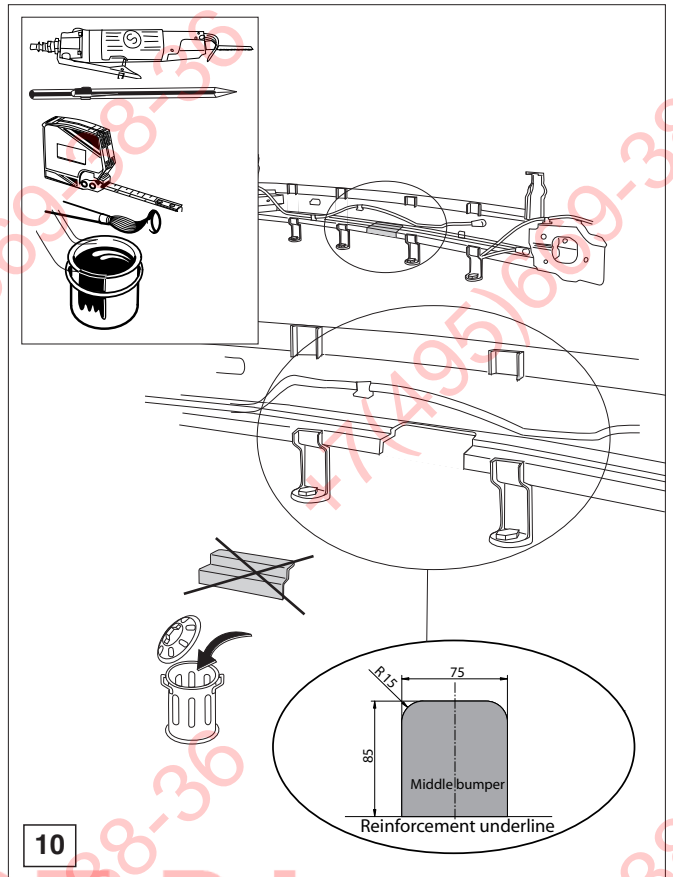
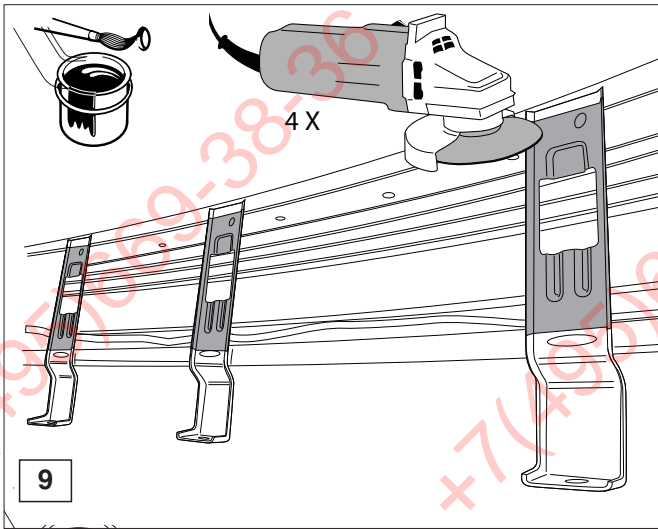

© 465770/25-01-2012/9

ФАРКОП.РФ

+7 (495) 669-38-36

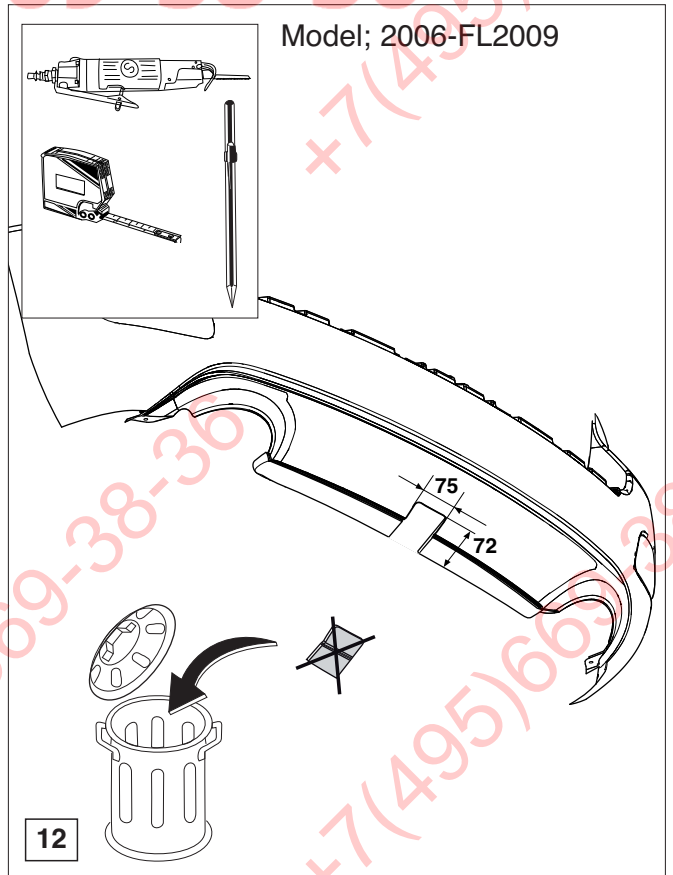
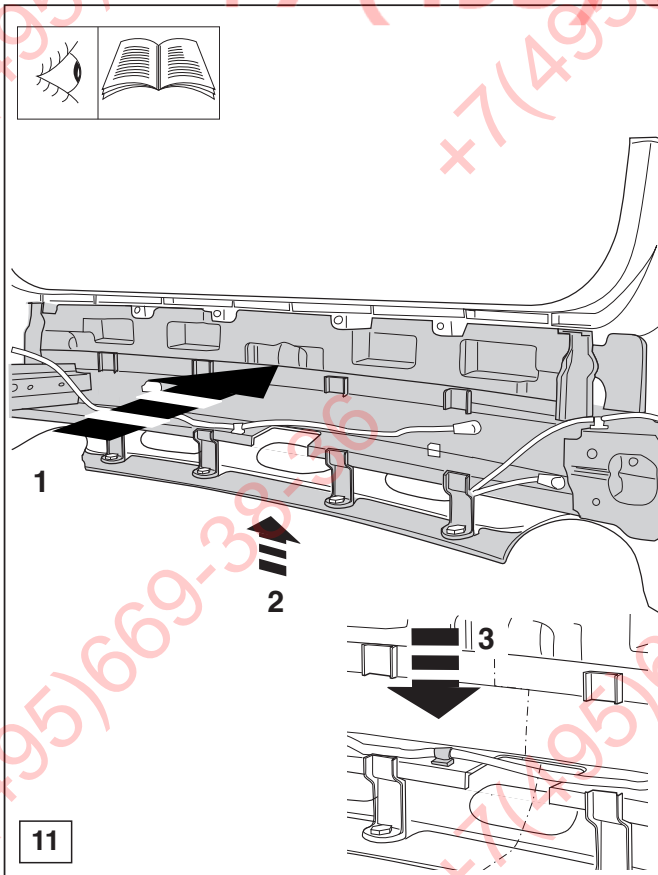

© 465770/25-01-2012/10